



# INFORMATION PACK FOR ALL BANDS COMPETING IN THE CHAMPIONSHIP SECTION 2017

## **WELCOME to Wychavon 2017!**

All of this info has been prepared in response to requests from bands in the past . **Please share this info with your band members!**

Here you will find information about road access to the venues and information about the halls in which you will play. Please note all the details given here are subject to change.

The pack includes:

- Access maps to get you in and out of Evesham, including the post code for Sat Nav users.
- General plans of the venues at De Montfort and their relative positions.
- DIAGRAMS AND IMAGES OF EACH OF THE PLAYING HALLS FOR YOUR SECTION
- **PERCUSSION PROVISION AND LAYOUT**
- Info about catering arrangements

## **PARKING ARRANGEMENTS:**

**When you arrive at De Montfort school gates you will be directed to various parking areas by stewards.** Please listen to what they say!

**Coach parking** is still being arranged. We need to know how many coaches will turn up so please let Kevin know asap so we can organise this. There is a small area set aside at the school for coach parking. The maps show other possible coach parking areas.

**Car parking:** At De Montfort main site there are a small number of places only for band and public car parking. Priority goes to committee, adjudicators and traders.

However, there is ample parking (80 places) at the (now closed) De Montfort Lower School. Which is about 150 metres away. A shuttle bus will run between the sites for most of the day.



## GETTING THERE!

De Montfort School  
 Four Pools Road,  
 Evesham,  
 Worcestershire  
 WR11 1DQ

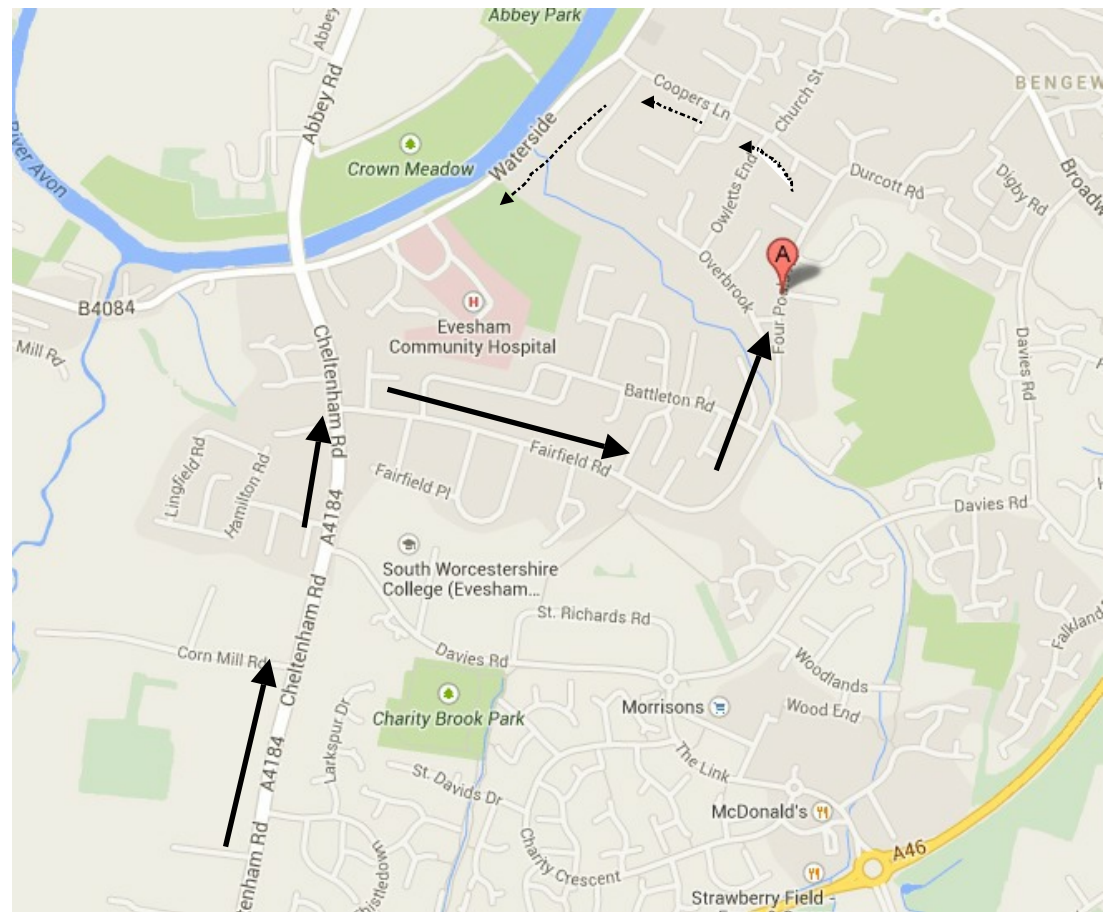
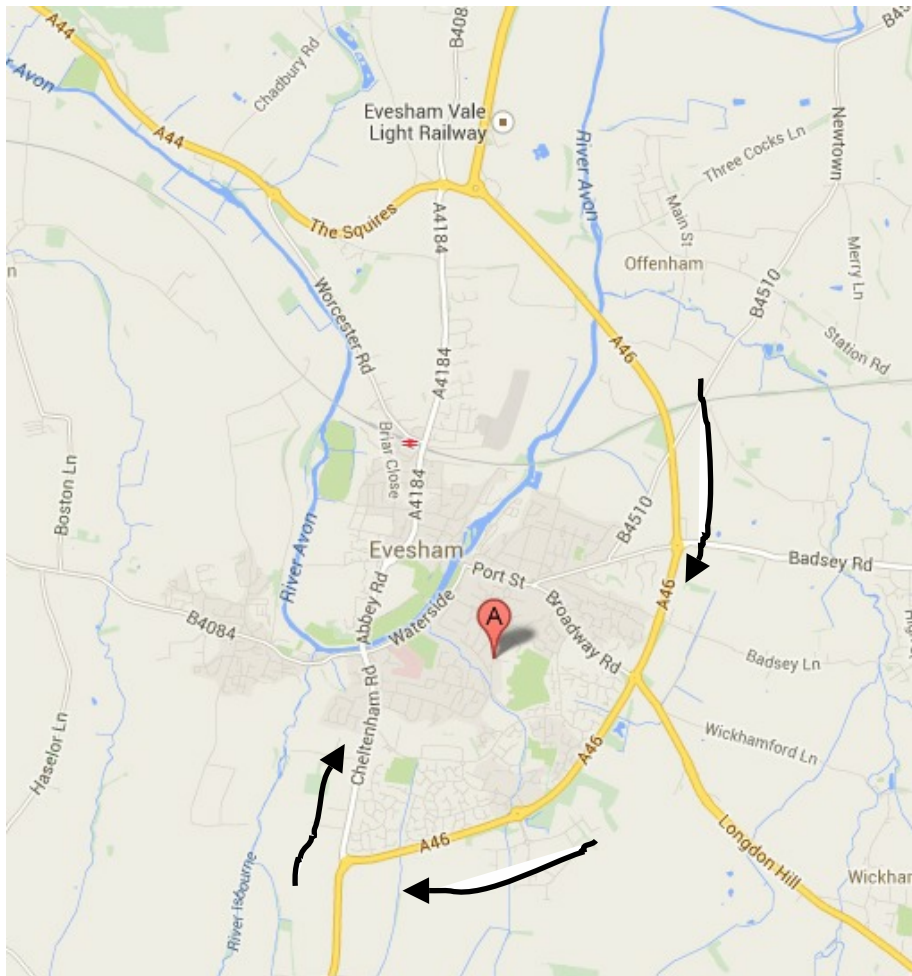

### Access to De Montfort High School:

**From the North:** go along A46 following the by-pass (yellow on the map) round the town to the southern most point. Once meeting the roundabout at the Cheltenham road go right along the A4184 towards the town centre. Turn right onto Fairfield Road. This leads into Four Pools Road. Both schools are on the right (A on map).

De Montfort School is on Four Pools Lane, just off four Pools Road.

**From the South:** Follow the direction given above from the Cheltenham Road roundabout.

After dropping off, coaches should carry on along Four Pools Road into Coopers Lane and then left along Waterside. This route avoids going through the town centre. FULL INFO ABOUT COACH PARKING ETC TO FOLLOW.



De Montfort School  
Four Pools Road,  
Evesham,  
Worcestershire  
WR11 1DQ

**ALL Sections competing  
here in 2016.**

The De Montfort Middle  
School  
Four Pools Lane,  
Evesham,  
WR11 1DL

**No competition** but parking available  
this year!

ABOUT 150 METRES FROM THE MAIN  
BUILDING.

**A SHUTTLE BUS WILL BE IN OPERATION**

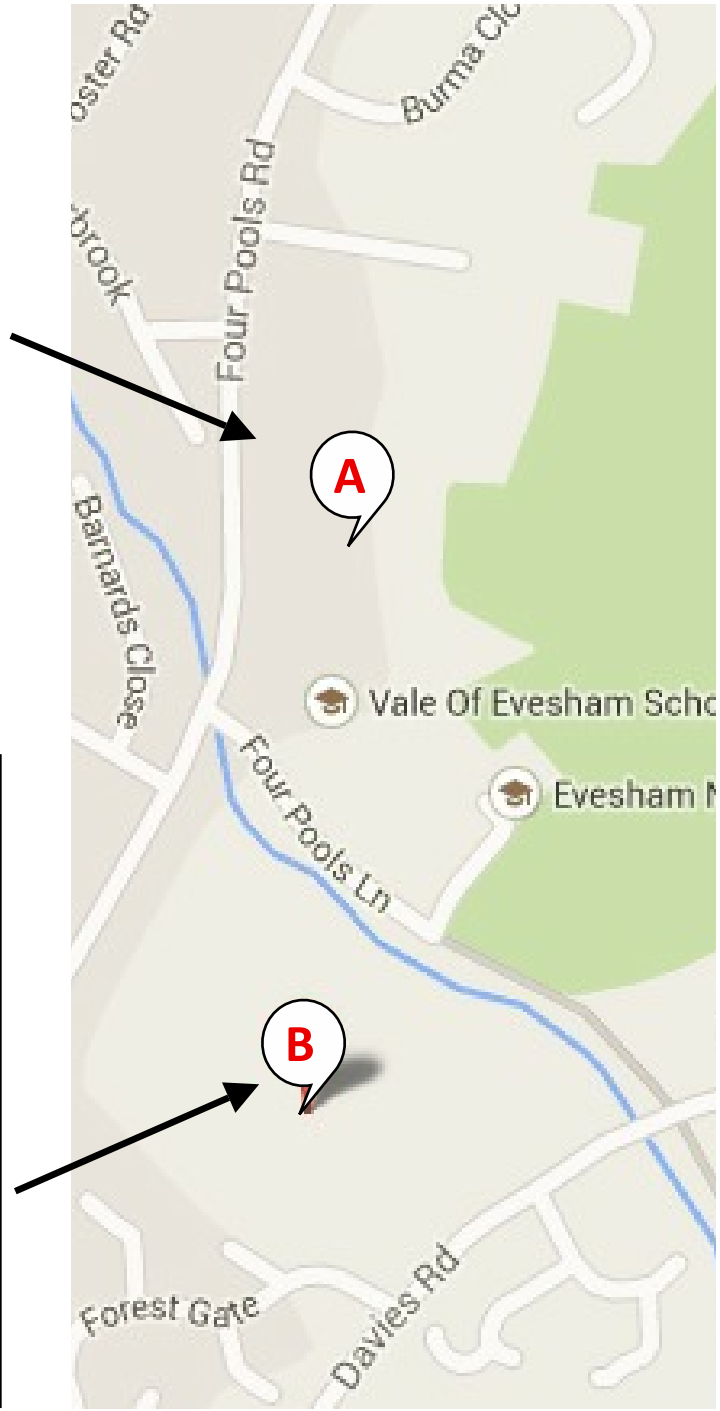

**Contest control**  
All Section Band Secs only  
to report here.

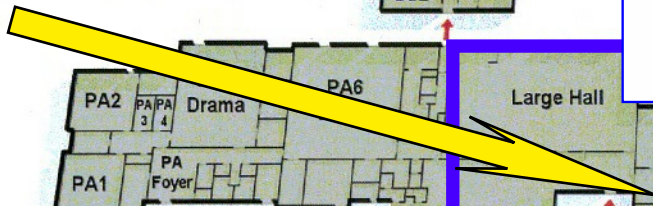

**Champ Section  
Main hall in  
Languages**

**Science**

**CAFE  
CORNER**

**Performing Arts**

**Languages**

**Design**

Smokers' corner

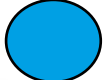

**BAND  
RECEPTION**

**Maths**

Pig Roast



**BAR  
AND  
FOOD**

**Humanities**

**Sections 3 and 4  
in Humanities Block**

Entry from the coach drop off point and  
main entrance on Four Pools Road.  
  
**Your band can wait in the BAND  
RECEPTION waiting area if wet until you  
receive your changing room allocation.**

De Montfort School  
Four Pools Road,  
Evesham,  
Worcestershire  
WR11 1DQ



= Information Point

**General Layout Plan : CHAMPIONSHIP SECTION**

(see following pages for details)

**De Montfort School (Main Building)**

**BAND ARRIVAL:** please go to Band Reception Area from main entrance to wait there (SEE General layout diagram)

**BAND SECS:** then please go to CONTEST CONTROL to collect your wrist bands and get your waiting room allocation.

**THEN:** Please go to your appointed WAITING AREA in the LANGUAGES BLOCK no sooner than ONE HOUR before you go on stage.

**After Registration** go back down the stairs to the **LARGE HALL** to compete.

**Return** the same way.

**Please vacate** your changing room after performing asap.

## Champ Section Venue Info

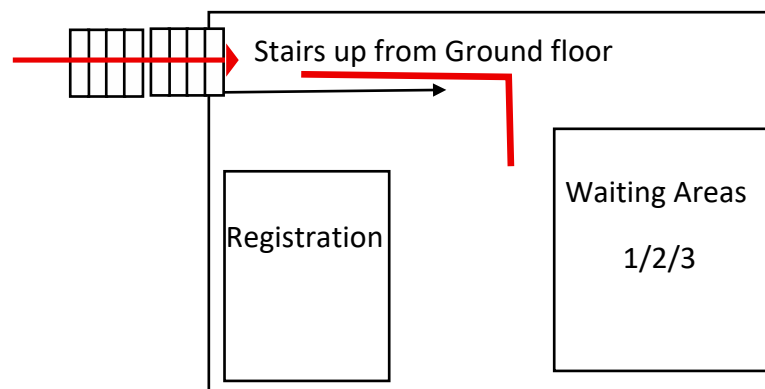

## LANGUAGES BLOCK

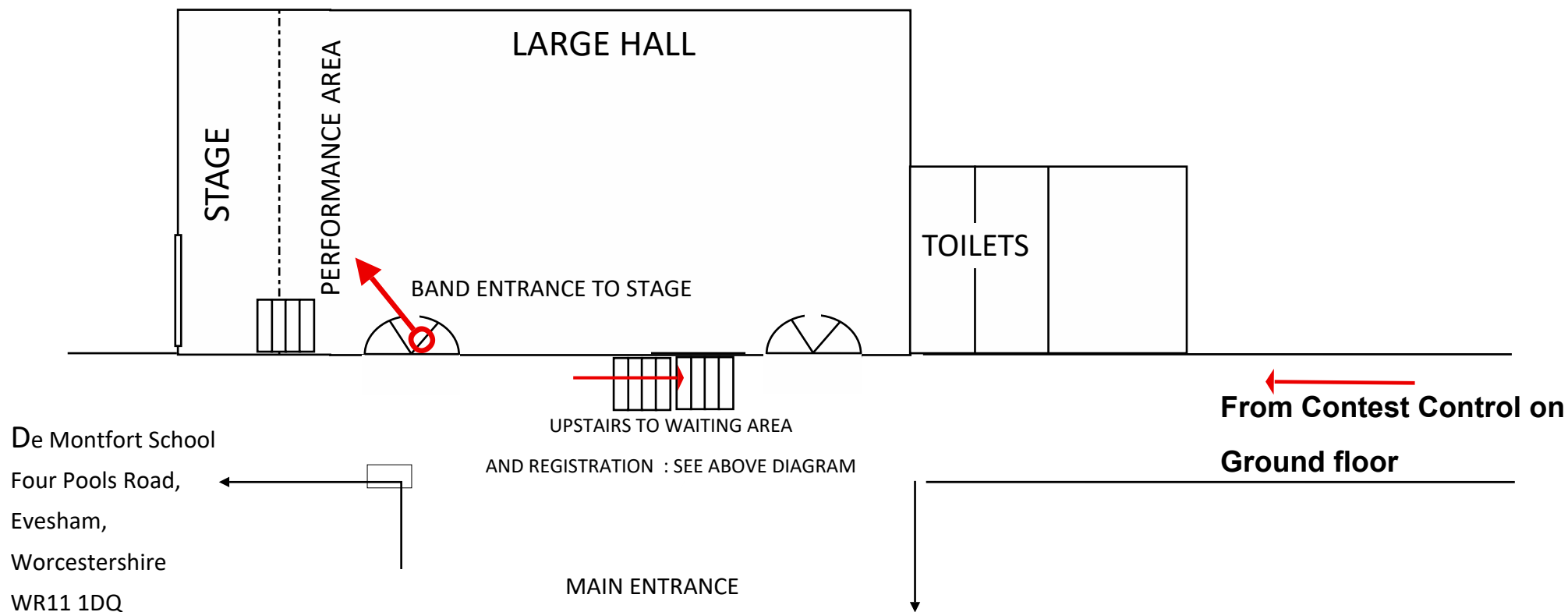

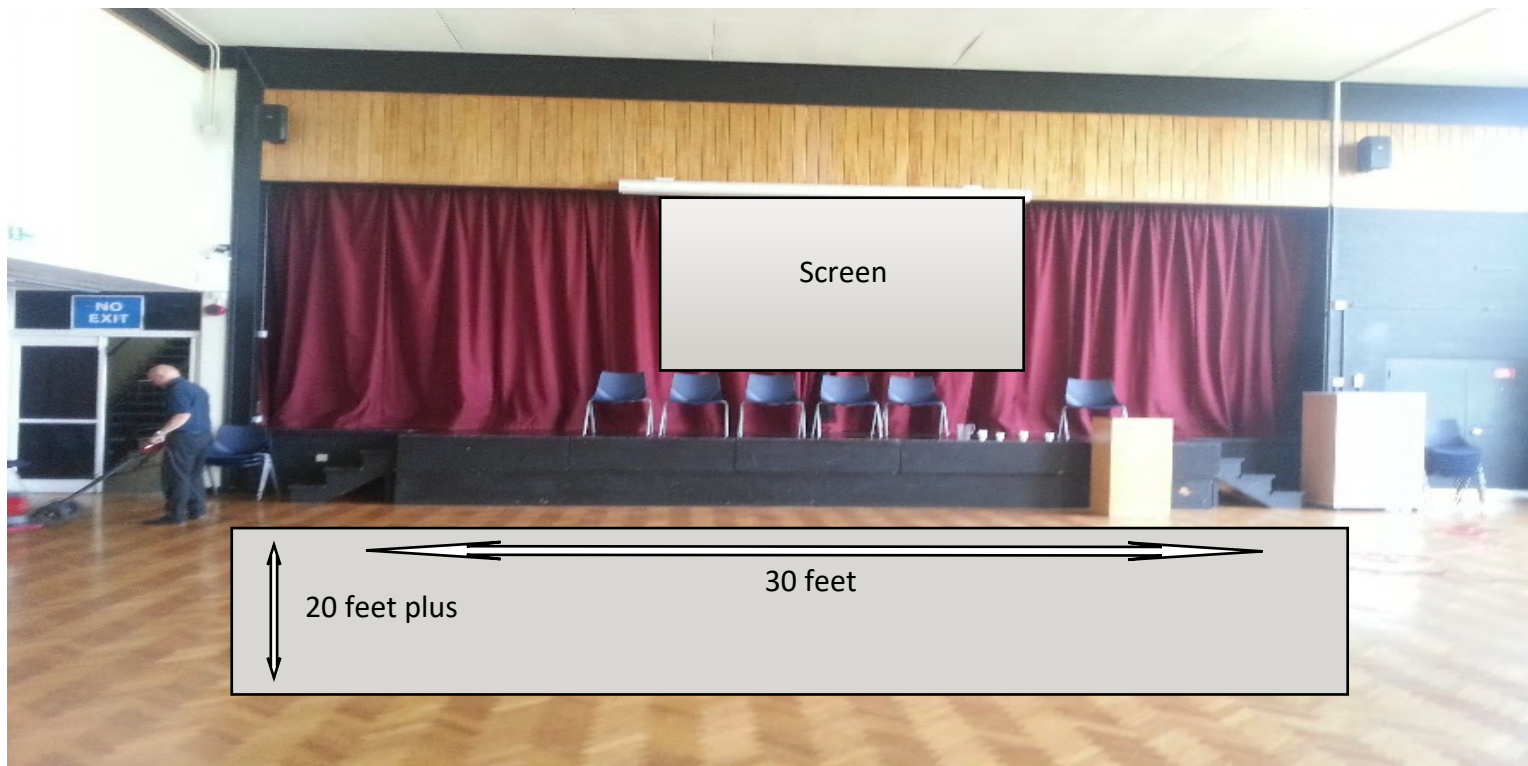

**The Large or Main Hall.** This is where the **Championship Section** plays.

**We will set up on the floor area in FRONT of the stage. The stage is simply too small to house a band plus percussion.** However, should you need the stage itself for any reason please let us know in advance of the competition so we can ensure that it is clear and ready for use. **There is screen as shown for audio visual work.**

**IF YOU INTEND PROVIDING AUDIO VISUALS TO ACCOMPANY YOUR PERFORMANCE PLEASE CONTACT**

**Steve Price: [sprice@prg.com](mailto:sprice@prg.com) or 07711591937** for details of correct file format for use with our equipment.

**Approximate width of the hall floor area is fifty feet.** The door shown on the left of the picture will not be in use as it leads out into a corridor. Please see the ground plan which shows access points which are on the left.

There will be carpeting and lightweight curtains but please be aware this is a **boomy** acoustic.

**WFB WILL PROVIDE THE FOLLOWING PERCUSSION  
IN EACH HALL:**

- 4 x Timpani & stool (32"/30"/28"/25")
- 1 x Xylophone
- 1 x Tubular Bells
- 1 x Concert Bass Drum
- 1 x Tam Tam
- 1 x Drum Kit
- 1 x Glock
- 1 x Vibraphone
- 1 x percussion technician

**PLEASE NOTE:**

Any further percussion instruments required other than that provided by the Festival Management, must be provided by the band, and will need to be agreed with the WFB Contest Secretary by 14th October, 2017.

Contest Secretary:

**Kevin Whittaker: 07970816696**

**kevinwhittaker@blueyonder.co.uk**

**Percussion Layout: The Timps and the Kit are in fixed positions as shown.**

Anything else can be moved– but please consult with the technician.

**And please try to ensure that all percussion is returned to the original positions  
BEFORE leaving the stage! Thank you!**

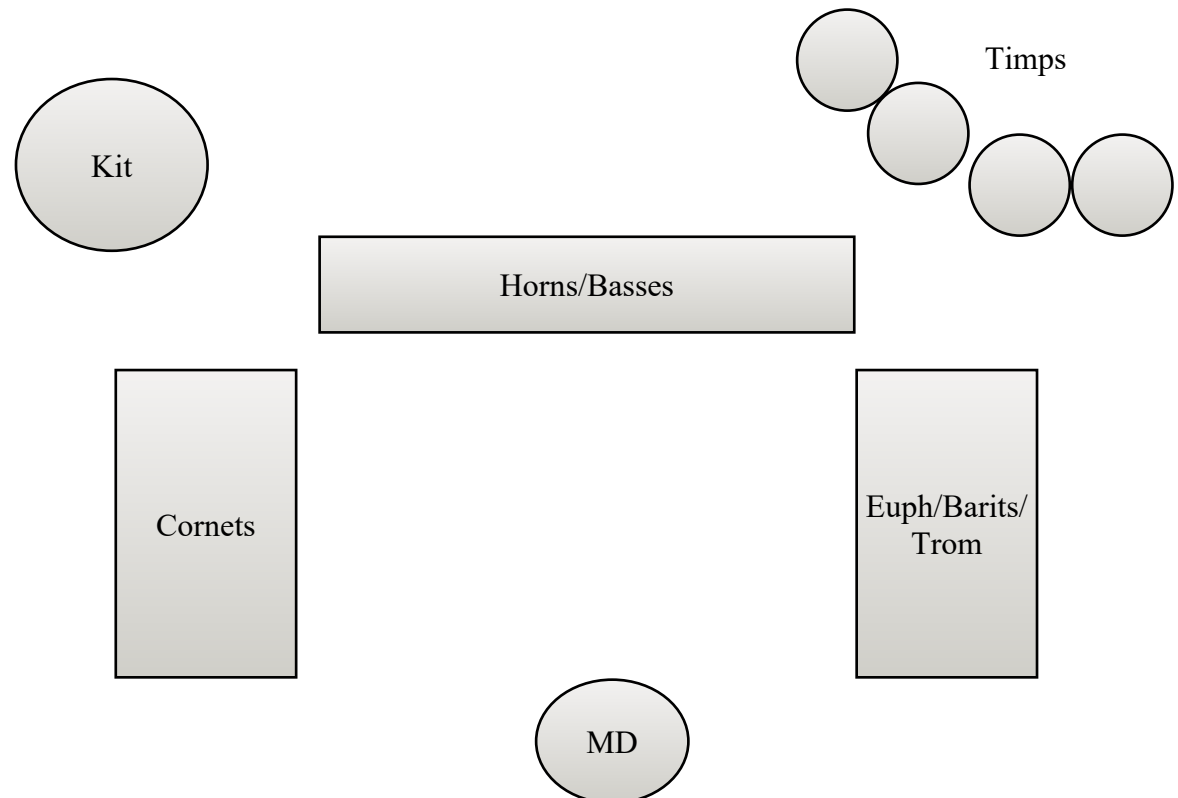

## Catering arrangements for 2017

The Fleece Inn will be providing reasonably priced catering services throughout the day, starting at about 9.00am:

As in previous years, **a full bar will be in operation** serving alcoholic drinks and beverages.

Breakfast baps, snacks and delicatessen foods should be available throughout the day in the bar area.

**Cafe Corner**, will be open too, offering teas, coffee and sandwiches and cakes. Please see the map for its position. It will be easily accessed from the Main Hall area and the bar.

Opening times are still under discussion but from early morning .

If you've not tried the now famous **Pig Roast** – do give it a try! Shown as a



Pig Roast

All our catering is close together allowing for easy movement between the different facilities.

**The bar will close at 10.30pm.**

A full food tariff will be available on the day. In addition, Evesham has many food and bar outlets should you wish to go off site.